

TEXAS OFFICIAL WOOD DESTROYING INSECT REPORT

1234 Easy Street

Inspected Address

Anywhere

City

USA

Zip Code

SCOPE OF INSPECTION

- A. This inspection covers only the multi-family structure, primary dwelling or place of business. Sheds, detached garages, lean-tos, fences, guest houses or any other structure will not be included in this inspection report unless specifically noted in Section 5 of this report.
- B. This inspection is limited to those parts of the structure(s) that are visible and accessible at the time of the inspection. Examples of inaccessible areas include but are not limited to (1) areas concealed by wall coverings, furniture, equipment and stored articles and (2) any portion of the structure in which inspection would necessitate removing or defacing any part of the structure(s) (including the surface appearance of the structure). **Inspection does not cover any condition or damage which was not visible in or on the structure(s) at time of inspection but which may be revealed in the course of repair or replacement work.**
- C. Due to the characteristics and behavior of various wood destroying insects, it may not always be possible to determine the presence of infestation without defacing or removing parts of the structure being inspected. Previous damage to trim, wall surface, etc., is frequently repaired prior to the inspection with putty, spackling, tape or other decorative devices. Damage that has been concealed or repaired may not be visible except by defacing the surface appearance. **The WDI inspecting company cannot guarantee or determine that work performed by a previous pest control company, as indicated by visual evidence of previous treatment; has rendered the pest(s) inactive.**
- D. If visible evidence of active or previous infestation of listed wood destroying insects is reported, it should be assumed that some degree of damage is present.
- E. If visible evidence is reported, it does not imply that damage should be repaired or replaced. Inspectors of the inspection company usually are not engineers or builders qualified to give an opinion regarding the degree of structural damage. Evaluation of damage and any corrective action should be performed by a qualified expert.
- F. **THIS IS NOT A STRUCTURAL DAMAGE REPORT OR A WARRANTY AS TO THE ABSENCE OF WOOD DESTROYING INSECTS.**
- G. If termite treatment (including pesticides, baits or other methods) has been recommended, the treating company must provide a diagram of the structure(s) inspected and proposed for treatment, label of pesticides to be used and complete details of warranty (if any). At a minimum, the warranty must specify which areas of the structure(s) are covered by warranty, renewal options and approval by a certified applicator in the termite category. Information regarding treatment and any warranties should be provided by the party contracting for such services to any prospective buyers of the property. The inspecting company has no duty to provide such information to any person other than the contracting party.
- H. There are a variety of termite control options offered by pest control companies. These options will vary in cost, efficacy, areas treated, warranties, treatment techniques and renewal options.
- I. There are some specific guidelines as to when it is appropriate for corrective treatment to be recommended. Corrective treatment may only be recommended if (1) there is visible evidence of an active infestation in or on the structure, (2) there is visible evidence of a previous infestation with no evidence of a prior treatment.
- J. If treatment is recommended based solely on the presence of conducive conditions, a preventive treatment or correction of conducive conditions may be recommended. The buyer and seller should be aware that there may be a variety of different strategies to correct the conducive condition(s). These corrective measures can vary greatly in cost and effectiveness and may or may not require the services of a licensed pest control operator. There may be instances where the inspector will recommend correction of the conducive conditions by either mechanical alteration or cultural changes. Mechanical alteration may be in some instances the most economical method to correct conducive conditions. If this inspection report recommends any type of treatment and you have any questions about this, you may contact the inspector involved, another licensed pest control operator for a second opinion, and/or the Structural Pest Control Board.

1A. Burgess Inspection Group 1B. 9156
 Name of Inspection Company SPCB Business License Number

1C. 2100 N. Collins #320 Richardson, TX 75080 972-690-3838
 Address of Inspection Company City State Zip Telephone No.

1D. Burgess Inspector 1.E Certified Applicator (check one)
 Name of Inspector (Please Print) Technician

2. N/A 3. Inspection Date
 Case Number (VA/FHA/Other) Inspection Date

4A. Universal Apartments Seller Agent Buyer Management Co. Other
 Name of Person Purchasing Inspection

4B. N/A
 Owner/Seller

4C. REPORT FORWARDED TO: Title Company or Mortgagee Purchaser of Service Seller Agent Buyer
 (Under the Structural Pest Control regulations only the purchaser of the service is required to receive a copy)

The structure(s) listed below were inspected in accordance with the official inspection procedures adopted by the Texas Structural Pest Control Board. This report is made subject to the conditions listed under the Scope of Inspection. A diagram must be attached including all structures inspected.

5. Multi-Family Residence, Pier & Beam, Brick & Wood.
 List structure(s) inspected that may include residence, detached garages and other structures on the property. (Refer to Part A, Scope of Inspection)

Licensed and Regulated by the Structural Pest Control Board
 PO Box 1927
 Austin, Texas 78767-1927
 (512) 305-8250

TEXAS OFFICIAL WOOD DESTROYING INSECT REPORT

6A. Were any areas of the property obstructed or inaccessible? Yes No
 (Refer to Part B & C, Scope of Inspection) If "Yes" specify in 6B.

6B. The obstructed or inaccessible areas include but are not limited to the following:

Attic	<input checked="" type="checkbox"/>	Insulated area of attic	<input checked="" type="checkbox"/>	Plumbing Areas	<input checked="" type="checkbox"/>	Planter box abutting structure	<input type="checkbox"/>
Deck	<input type="checkbox"/>	Sub Floors	<input checked="" type="checkbox"/>	Slab Joints	<input checked="" type="checkbox"/>	Crawl Space	<input checked="" type="checkbox"/>
Soil Grade Too High	<input type="checkbox"/>	Heavy Foliage	<input type="checkbox"/>	Eaves	<input checked="" type="checkbox"/>	Weepholes	<input type="checkbox"/>

Other Specify: Wall & Floor Coverings, Mechanical Voids, Appliances, Cabinets, Furniture & Stored Items, Closets.

7A. Conditions conducive to wood destroying insect infestation: Yes No
 (Refer to Part J, Scope of Inspection) If "Yes" specify in 7B.

7B. Conducive Conditions include but are not limited to:

Debris under or around structure (K)	<input type="checkbox"/>	Wood to Ground Contact (G)	<input type="checkbox"/>	Form boards left in place (I)	<input checked="" type="checkbox"/>
Footing too low or soil line too high (L)	<input type="checkbox"/>	Excessive Moisture (J)	<input checked="" type="checkbox"/>	Wood Rot (M)	<input checked="" type="checkbox"/>
Planter box abutting structure (O)	<input type="checkbox"/>	Heavy Foliage (N)	<input type="checkbox"/>	Insufficient ventilation (T)	<input type="checkbox"/>
Wood Pile in Contact with Structure (Q)	<input type="checkbox"/>	Wooden Fence in Contact with the Structure (R)	<input type="checkbox"/>		

Other (C) Specify: _____

8. Inspection Reveals Visible Evidence in or on the structure:	Active Infestation	Previous Infestation	Previous Treatment
8A. Subterranean Termites	Yes <input type="checkbox"/> No <input checked="" type="checkbox"/>	Yes <input checked="" type="checkbox"/> No <input type="checkbox"/>	Yes <input type="checkbox"/> No <input checked="" type="checkbox"/>
8B. Drywood Termites	Yes <input type="checkbox"/> No <input checked="" type="checkbox"/>	Yes <input type="checkbox"/> No <input checked="" type="checkbox"/>	Yes <input type="checkbox"/> No <input checked="" type="checkbox"/>
8C. Formosan Termites	Yes <input type="checkbox"/> No <input checked="" type="checkbox"/>	Yes <input type="checkbox"/> No <input checked="" type="checkbox"/>	Yes <input type="checkbox"/> No <input checked="" type="checkbox"/>
8D. Carpenter Ants	Yes <input checked="" type="checkbox"/> No <input type="checkbox"/>	Yes <input type="checkbox"/> No <input checked="" type="checkbox"/>	Yes <input type="checkbox"/> No <input checked="" type="checkbox"/>
8E. Other Wood Destroying Insects	Yes <input type="checkbox"/> No <input checked="" type="checkbox"/>	Yes <input type="checkbox"/> No <input checked="" type="checkbox"/>	Yes <input type="checkbox"/> No <input checked="" type="checkbox"/>

Specify: _____

8F. Explanation of signs of previous treatment (including pesticides, baits, existing treatment stickers or other methods) identified: NO SIGNS OF TREATMENT

8G. Visible evidence of: Previous Termite Infestation, Active Carpenter Ant Infestation has been observed in the following areas: Interior walls of Apartment Units, Workshop and Active Carpenter Ants and damage at door frames of building 3517

If there is visible evidence of active or previous infestation, it must be noted. The type of insect(s) must be listed in the first blank and all identified infested areas of the property inspected must be noted in the second blank. (Refer to Part D, E & F, Scope of Inspection)

The conditions conducive to insect infestation reported in 7A & 7B:

9. Will be or has been mechanically corrected by inspecting company: Yes No
 If "Yes," specify corrections: _____

9A. Corrective treatment recommended for active infestation or evidence of previous infestation with no prior treatment as identified in Section 8. (Refer to Part G, H, and I, Scope of Inspection) Yes No

9B. A preventive treatment and/or correction of conducive conditions as identified in 7A & 7B is recommended as follows: Yes No
 Specify reason: I-form Board, M-Wood Rot, J-Excessive Moisture
 Refer to Scope of Inspection Part J

10A. This company has treated or is treating the structure for the following wood destroying insects: N/A
 If treating for subterranean termites, the treatment was: Partial Spot Bait Other
 If treating for drywood termites or related insects, the treatment was: Full Limited

10B. N/A N/A N/A
 Date of Treatment by Inspecting Company _____ Common Name of Insect _____ Name of Pesticide, Bait or Other Method _____

This company has a contract or warranty in effect for control of the following wood destroying insects:
 Yes No List Insects: N/A
 If "Yes", copy (s) of warranty and treatment diagram must be attached.

TEXAS OFFICIAL WOOD DESTROYING INSECT REPORT

Diagram of Structure(s) Inspected

The inspector must draw a diagram including approximate perimeter measurements and indicate active or previous infestation and type of insect by using the following codes: E-Evidence of Infestation, A-Active; P-Previous; D-Drywood Termites; S-Subterranean Termites; F-Formosan Termites; C-Conducive Conditions; B-Wood Boring Beetles; H-Carpenter Ants; Other(s) - Specify **PS-Evidence of Previous Termites, AH-Active Carpenter Ants, M-Wood rot, I-Form boards, J-Excessive moisture,**

.....Obstructed/Inaccessible

I-FORMBOARD M-DOOR TRIM

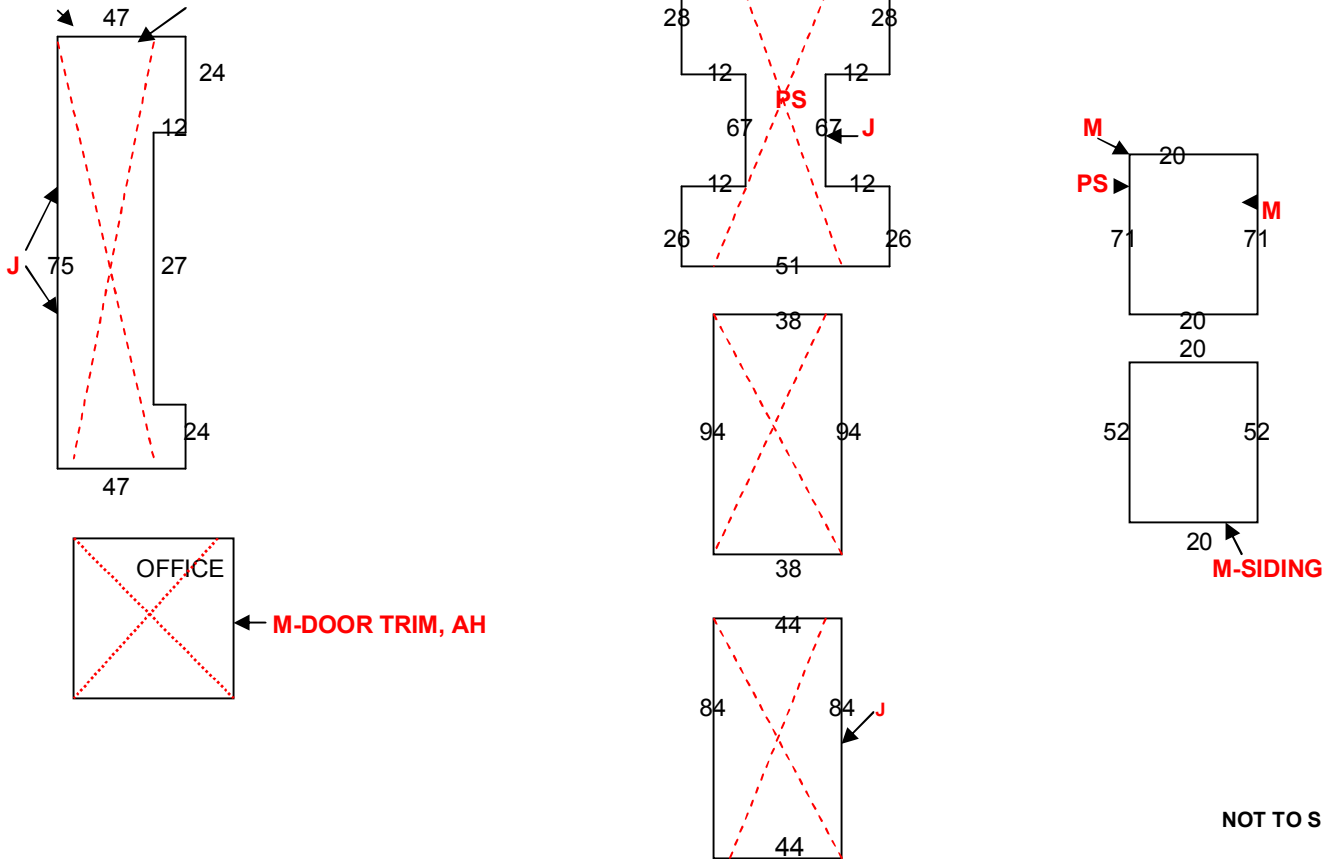

NOT TO SCALE

Additional Comments Active Carpenter Ant Infestation. Treatment Recommended. Previous Termite Infestation with no signs of treatment, Treatment Recommended or previous treatment document by licensed pest control company.

Neither I nor the company for which I am acting have had, presently have, or contemplate having any interest in the property. I do further state that neither I nor the company for which I am acting is associated in any way with any party to this transaction.

Signatures:

11A. Burgess Inspector
Inspector

Approved:

11B. Burgess Inspector
Certified Applicator and Certified Applicator License Number

Notice of Inspection Was Posted At or Near

- 12A. Electric Breaker Box
- Water Heater Closet
- Bath Trap Access
- Beneath the Kitchen Sink

12B. Date Posted July 26, 2006
Date

Statement of Purchaser

I have received the original or a legible copy of this form. I have read and understand any recommendations made. I have also read and understand the "Scope of Inspection." I understand that my inspector may provide additional information as an addendum to this report.

If additional information is attached, list number of pages: _____

Signature of Purchaser of Property or their Designee

Date

Licensed and Regulated by the Structural Pest Control Board
PO Box 1927
Austin, Texas 78767-1927
(512) 305-8250